

Quick Start Guide

EECN1-LN1-X-MX-B

EoC Transmitter & Receiver - 1 RJ45 and 1 BNC Port

Introduction

The KBC EECN1-LN1-X-MX-B is a fully ruggedized Ethernet over Coax transmitter & receiver set. This product provides connectivity for one 10/100Mbps IEEE standard twisted pair copper port over a 75ohm coaxial cable. Varying data rates are supported depending on cable distance and quality. The plug-and-play design ensures ease of installation with no electrical adjustment needed. LED indicators are provided to show the operational status of the unit.

The size of the transmitter is suited for fitting inside a camera housing and where space is minimal.

Features

- 1 UTP port and 1 coax port
- 12-24VDC power input
- Coax data rate >50Mbps (300m) based on coax quality
- Complete protection design including surge protection and lightning protection

Downloads

Full specifications, features and additional information can be found on the KBC website: www.kbcnetworks.com.

General

Check the product upon receipt for any visible damage which may have been caused during shipping.

Physical Deployment

This equipment must be installed and operated in accordance with instructions found in this document. Failure to comply with these instructions will invalidate warranty.

Application

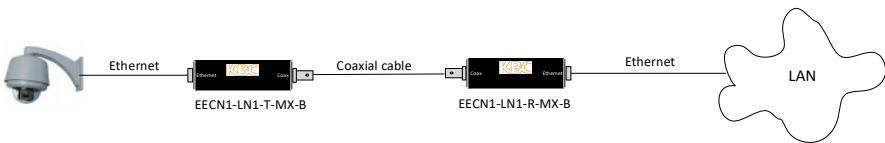

Panel Views

Top View (Transmitter)

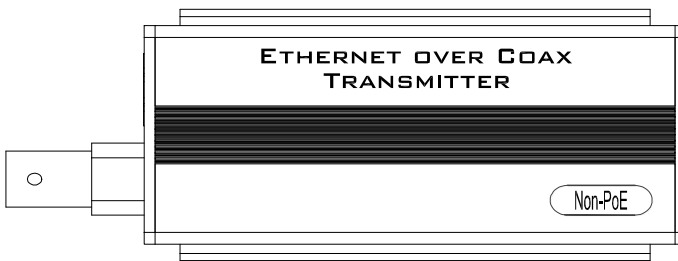

Top View (Receiver)

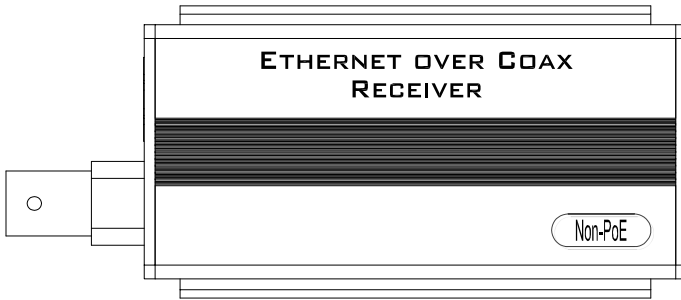

Side View

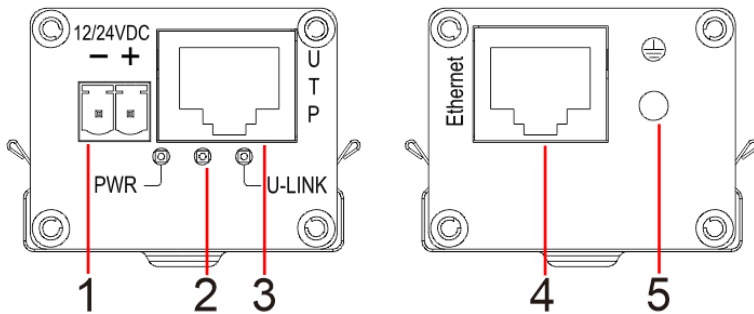

Coax panel

Ethernet panel

1 - Power input; 2 - LED indicators; 3 - Coaxial cable connector;
4 - Ethernet RJ45 port; 5 - Grounding terminal

LED	Color	Status	Description
PWR	Orange	On	Power supply is normal.
C-LINK	Green	On	EoC connection is normal.
Ethernet Link/Act	Orange	On/Blink	On: Ethernet link is normal. Blink: Data is active.

RJ45 Definition

Pin	Signal
1	TD+
2	TD-
3	RD+
4	N/A
5	N/A
6	RD-
7	N/A
8	N/A

Dimensions (Unit = mm)

Equipment:

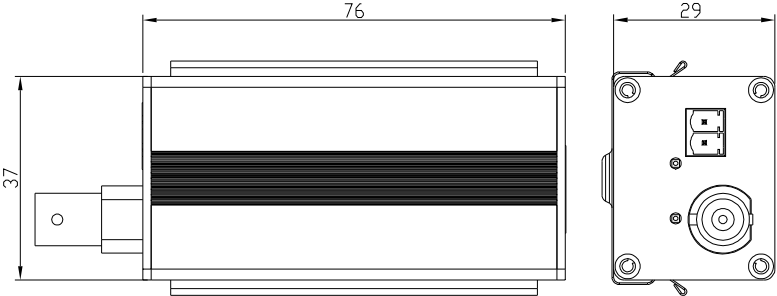

Installation Accessories:

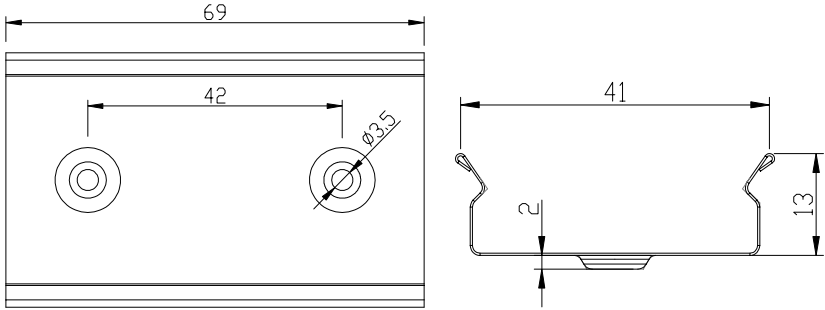

Specifications

Item		Description
Power	Power Input	12/24VDC
	Consumption	<2W
Cable	Transmission Medium	75-5 or above coaxial cable and Cat5e/6 cable
	Operating Frequency	2M-28M
	Modulation	Wavelet-OFDM
	Transmission Rate	210Mbps (Max.)
	Power Negotiation Cycle	1S
	Overcurrent	720mA
	Overcurrent Protection Time	<2mS
	Transmission Distance	*500m
Ethernet Port	Transmission Medium	Cat5e/6
	Standard	IEEE802.3, IEEE802.3U
	Ethernet Delay	<1mS
Protection	ESD	IEC61000-4-2
	Anti-Thunder Protection	IEC61000-4-5 level 3
Operation Environment	Operating Temperature	-20°C--+60°C
	Storage Temperature	-40°C--+85°C
	Humidity (Non-Condensing)	0-90%
Mechanical	Dimension (L×W×H)	76mm*37mm*29mm
	Material	Aluminum
	Color	Black
	Weight	0.2Kg

*Transmission distance depends on signal source and cable quality.

Installation Instructions

Please check the following items before installation. If any are missing, please contact the dealer.

- EoC transmitter/receiver----- x1
- Wall mounting clamp----- x1
- QSG/User manual ----- x1
- Screws ----- x2

Please follow the installation steps below:

- 1) Attach the clamp to the wall using the 2X10mm screws.

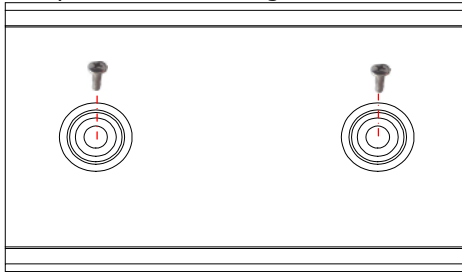

- 2) Press the transmitter/receiver into the clamp.

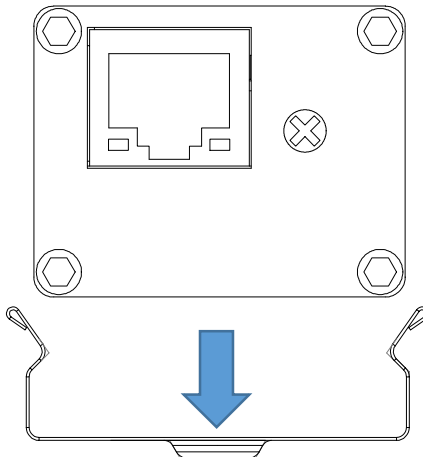

- 3) Use a network cable to connect the RJ45 port to the powered device (transmitter) or the Ethernet switch (receiver), use a coaxial cable to connect the BNC port of the transmitter and the receiver, and use a grounding wire to connect the grounding terminal.

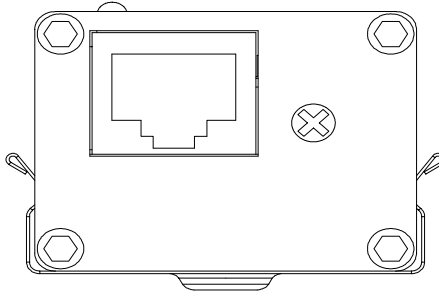

- 4) Check that the installation is correct and power on the device to be sure the device is operating normally.

Troubleshooting

Please refer to the following information if the device does not work:

- Confirm the installation is according to the factory installation requirements.
- Confirm the RJ45 cable order follows the EIA/TIA568A or 568B industry standards.
- The maximum transmission distance depends on the signal source and cable quality. Please do not exceed the maximum transmission distance.
- Please replace the failed device with a known working unit to determine if you have a damaged or faulty unit.
- If the problem persists, please contact your nearest KBC office or dealer.

Need Help?

Please visit our website www.kbcnetworks.com, or contact your nearest KBC office or dealer.